



Flat 1, 6 Genesta Road, Westcliff-On-Sea

Offers Over **£135,000**



Flat 1

6 Genesta Road, Westcliff-On-Sea

Council Tax band: A

Tenure: Leasehold

EPC Energy Efficiency Rating: D

EPC Environmental Impact Rating: E

- RARE PRIVATE DRIVEWAY PARKING SPACE
- COMMUNAL GARDEN
- GROUND FLOOR FLAT
- ONE DOUBLE BEDROOM
- NO ONWARD CHAIN
- CLOSE TO STATION
- GAS CENTRAL HEATING
- WELL MAINTAINED BUILDING



NO ONWARD CHAIN

Vacant possession 1 bedroom ground floor flat in Westcliff on sea with a private driveway, communal garden and side access.

This well maintained building hosts just 4 flats in total and is positioned on the south of London road in an ideal location for short walking distance to west-cliff train station.

Along with plenty of bus routes, local shops, popular restaurants, supermarkets and convenient amenities all within very close proximity.

Entrance to the property is well secured with a glass door porch leading to the double lock front door entering into the well maintained hall equipped with smoke alarms and emergency power with a cleaner coming regularly this is a clean safe space to live.

The front driveway hosts an allocated private space for the flat with secure side access into the generous sized rear garden. This property is a great opportunity for first time buyers, investors and landlords and has been priced in consideration for light modernization this. Viewing is advised to appreciate the high ceilings and potential.



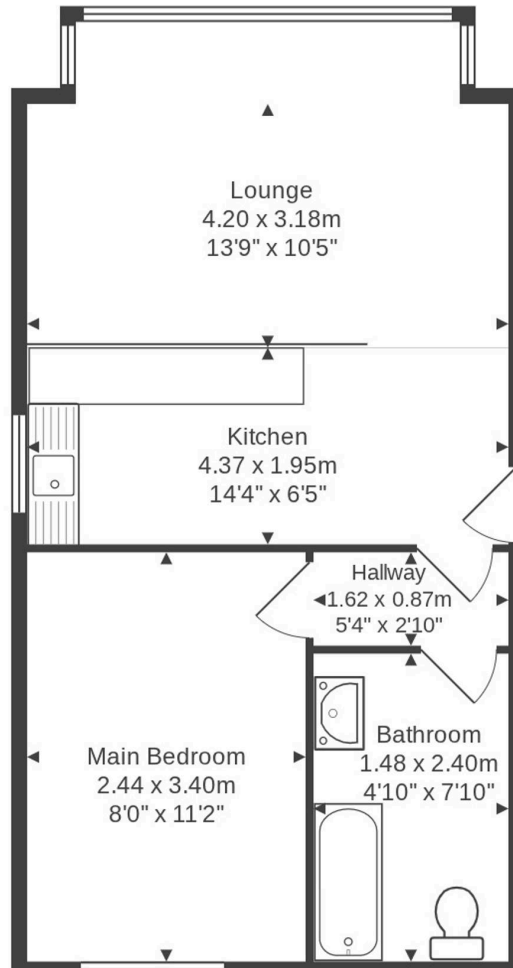

Measurements are approximate and for display purposes only considering wall depths in the living space and bay window.



Danielle Phillips - Hortons

Hadleigh, Essex SS7

07706469306 · danielle@hortons.co · hortons.co/



 HORTONS