



51 Gifford Road, Benfleet

Fixed Price £375,000





Council Tax band: C

Tenure: Freehold

Offered for sale with NO ONWARD CHAIN this stunning double fronted and generously sized 2 bedroom semi detached bungalow is up for sale in Benfleet and situated favorably South of the London road. Within easy distance of many local schools, shops and major routes via the A13 and A127. This property is in a quiet road offering a 4 car driveway with side access into the impressive 100ft garden where you can find unique features like the covered pergola for entertaining leading on from the open plan kitchen/diner. If your looking for something ready to move into or scope for change, this home is definitely advised to view to appreciate its full potential.



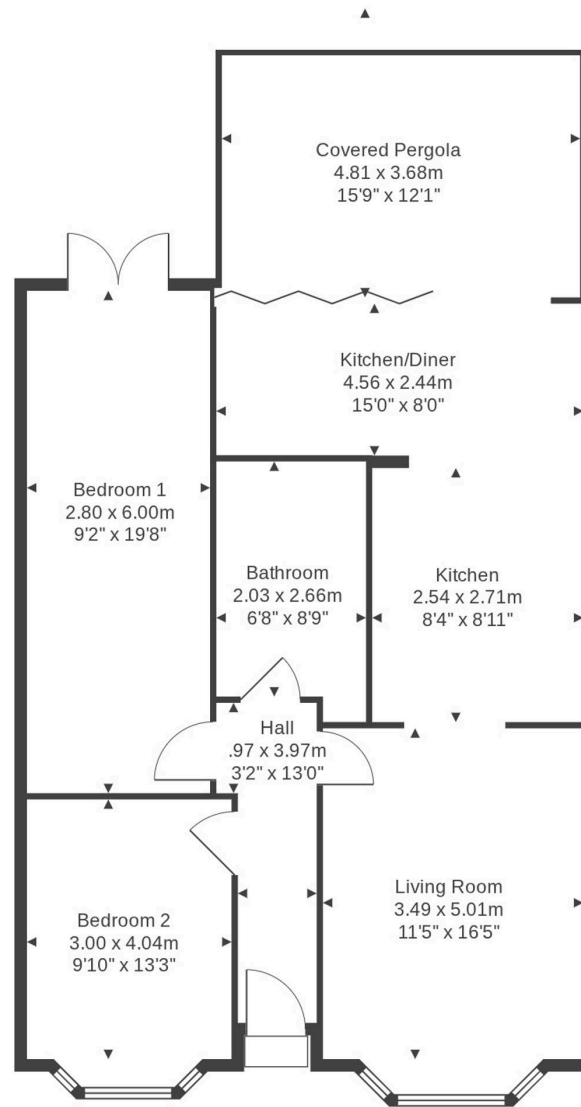

Total Area: 87.9 m<sup>2</sup> ... 947 ft<sup>2</sup>





**Danielle Phillips - Hortons**

Unit 11, Brook Park Gaddesby Lane - LE7 4ZB

07706469306 · [danielle@hortons.co](mailto:danielle@hortons.co) · [hortons.co/](http://hortons.co/)