



51 Gifford Road, Benfleet

Fixed Price £375,000

EPC Energy Efficiency Rating: C

Offered for sale with NO ONWARD CHAIN

This stunning double fronted and generously sized 2 bedroom semi detached bungalow is up for sale in Benfleet and situated favorably South of the London road.

Within easy distance of many local schools, shops and major routes via the A13 and A127. This property is in a quiet road offering a 4 car driveway with side access.

In the impressive 100ft garden you can find unique features like the covered pergola leading out from the kitchen bi-fold doors for entertaining leading on from the open plan kitchen/diner.

Both ready to move into or scope for change, this home is a blank canvas for either!

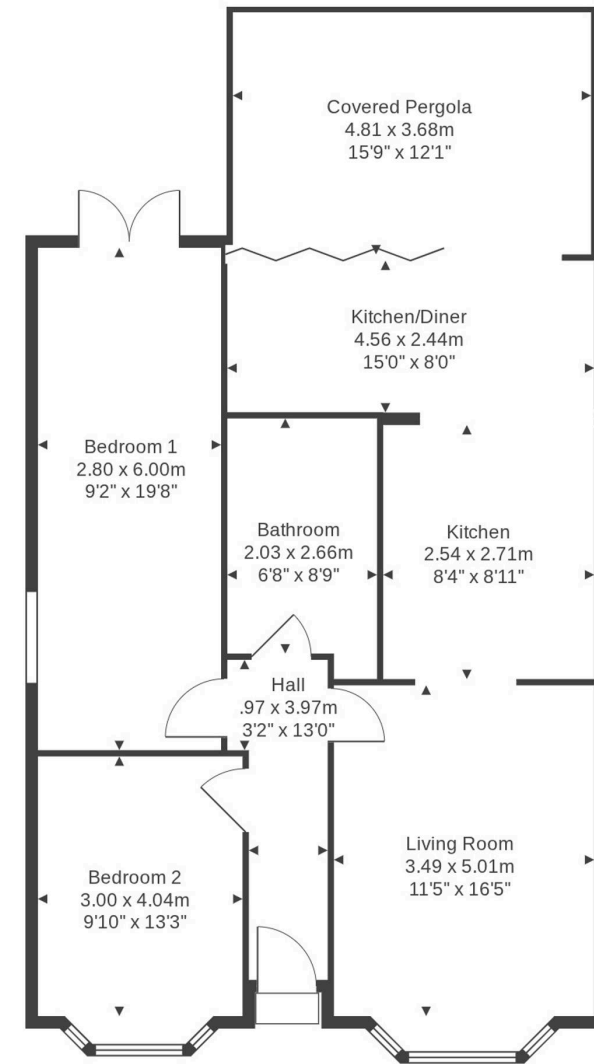

Total Area: 87.9 m<sup>2</sup> ... 947 ft<sup>2</sup>



## 51 Gifford Road

Benfleet, SS7

Council Tax band: C

Tenure: Freehold

- Covered Pergola
- 2 Double Bedrooms
- 3/4 Car Driveway
- 100 ft Garden
- Double Fronted and Extended
- Open plan kitchen/diner with bifold doors

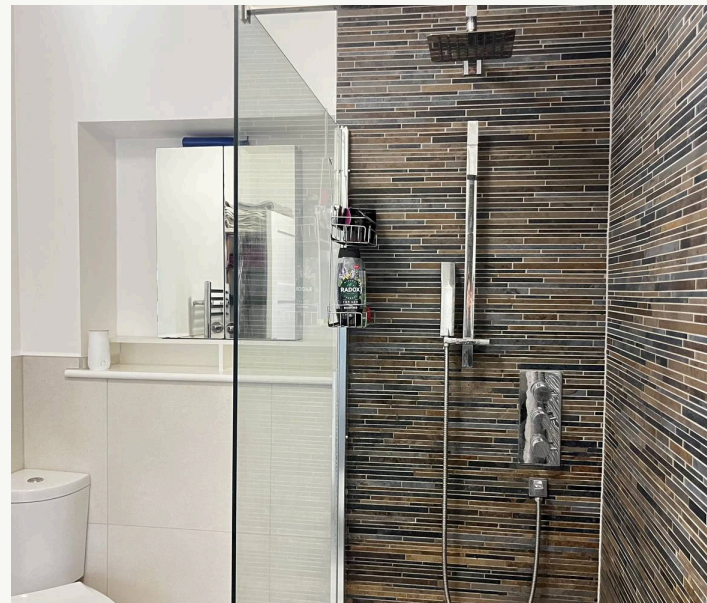





Danielle Phillips - Hortons

Unit 11, Brook Park Gaddesby Lane - LE7 4ZB

07706469306 · danielle@hortons.co · hortons.co/



 HORTONS